

PART V
**THE LOCATIONS AND THEIR ARCHITECTURAL
AND PLANNING PARAMETERS**

1. Targ Rybny
2. Tobiasza - Area A
3. Tobiasza - Area B
4. Grobla III - Straganiarska
5. Grobla III – Świętojańska
6. Szeroka, Tokarska
7. Klesza
8. Grząska
9. Ławnicza
10. Ogarna
11. Mniszki, Katarzynki

1. Targ Rybny

1.

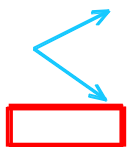
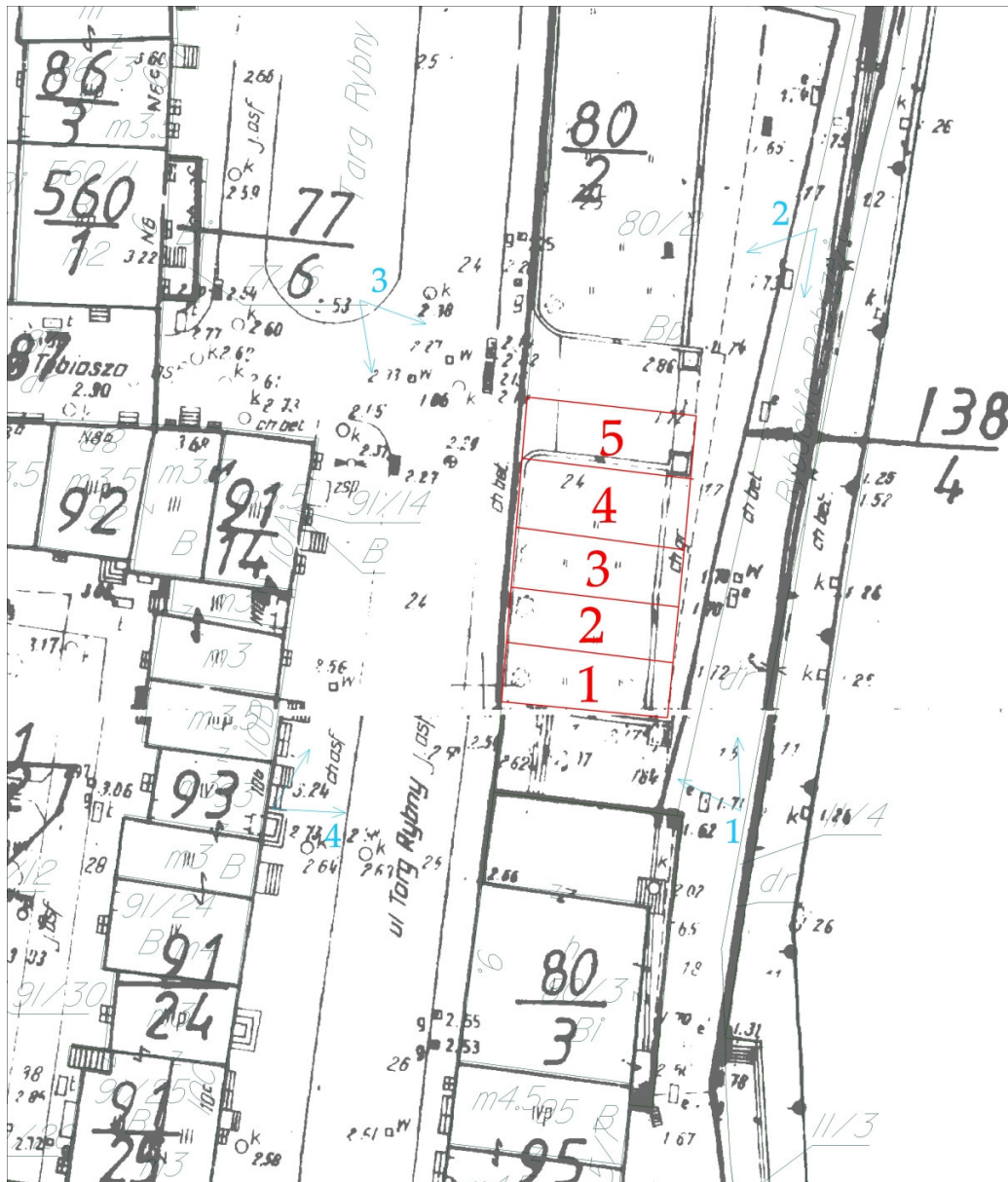

- photos taken from

- townhouses

1. Targ Rybny



1. Targ Rybny

TARG RYBNY STREET – Area 1

Lot No. 1:

- roof type – peaked
- facade layout – 4 storeys + gable
- building height (present ground level to the roof ridge) – maximum 19 m.

Lot No. 2:

- roof type – ridged
- facade layout – 4 storeys + gable
- building height (present ground level to roof ridge) – maximum 19 m.
- elements of the facade decorations can jut above the roof level – maximum 1.5 m.

Lot No. 3:

- roof type – ridged
- facade layout – 3 storeys + gable
- building height (present ground level to roof ridge) – maximum 16 m.

Lot No. 4:

- roof type – peaked
- facade layout – 4 storeys + gable
- building height (present ground level to roof ridge) – maximum 19 m.
- elements of the facade decorations can jut above the roof level – maximum 1.5 m.

Lot No. 5:

- roof type – peaked
- facade layout – 3 storeys + gable
- building height (present ground level to roof ridge) – maximum 16 m.
- elements of the facade decorations can jut above the roof level – maximum 1.5 m.

2. Tobiasza Area A

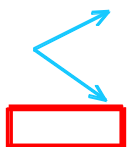
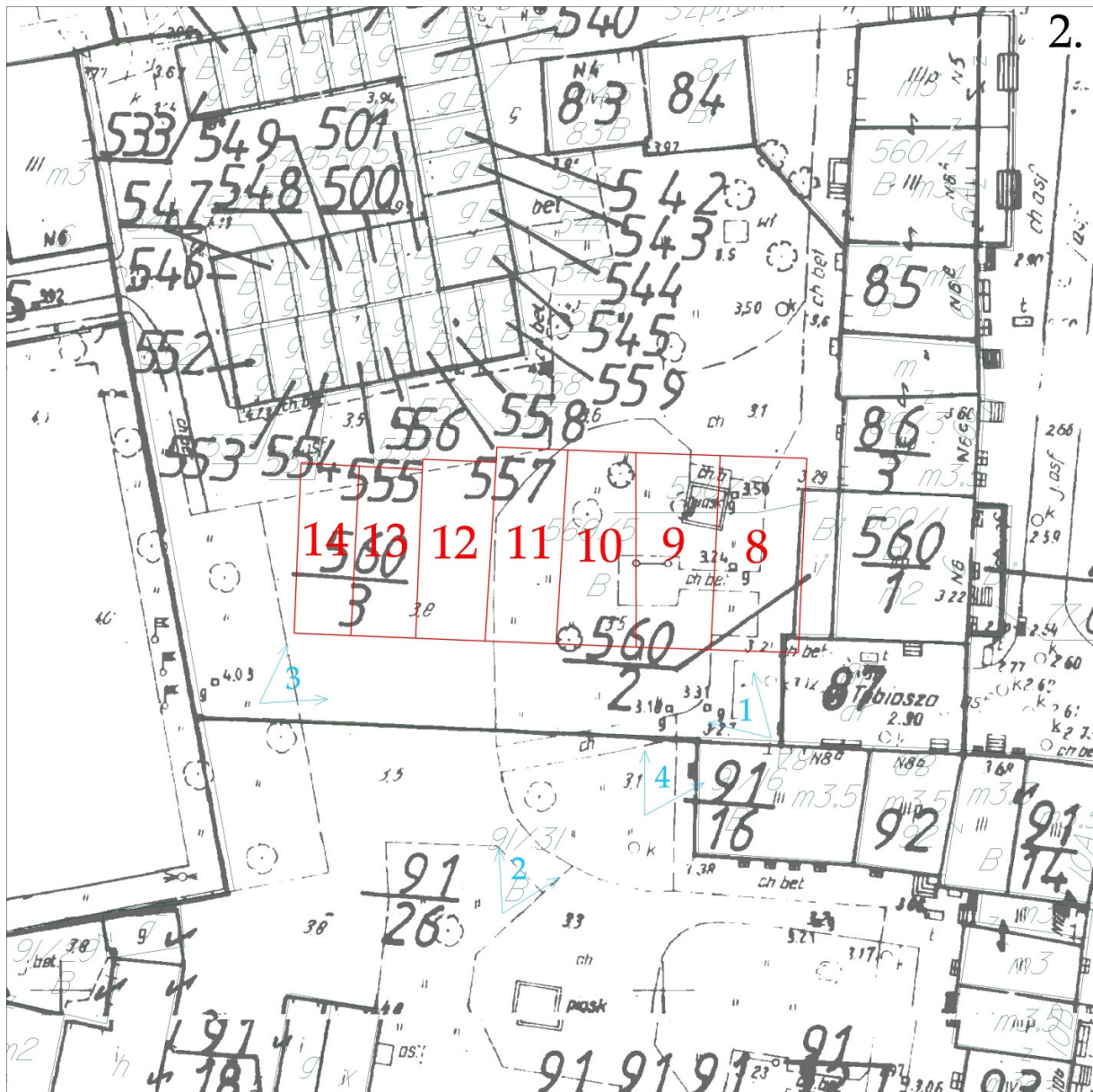

- photos taken from

- townhouses

2. Tobiasza Area A



2. Tobiasza Area A

TOBIASZA STREET Area A

Lot No. 8:

- roof type – peaked
- facade layout – 3 storeys + gable
- building height (present ground level to roof ridge) – maximum 16 m.
- elements of the facade decorations can jut above the roof level – maximum 1.5 m.

Lot No. 9:

- roof type – peaked
- facade layout – 4 storeys + gable
- building height (present ground level to roof ridge) – maximum 19 m.
- elements of the facade decorations can jut above the roof level – maximum 1.5 m.

Lot No. 10:

- roof type – peaked
- facade layout – 3 storeys + gable
- building height (present ground level to roof ridge) – maximum 16 m.
- elements of the facade decorations can jut above the roof level – maximum 1.5 m.

Lot No. 11:

- roof type – peaked
- facade layout – 4 storeys + gable
- building height (present ground level to roof ridge) – maximum 19 m.
- elements of the facade decorations can jut above the roof level – maximum 1.5 m.

Lot No. 12:

- roof type – peaked
- facade layout – 3 storeys + gable
- building height (present ground level to roof ridge) – maximum 16 m.
- elements of the facade decorations can jut above the roof level – maximum 1.5 m.

Lot No. 13:

- roof type – peaked
- facade layout – 3 storeys + gable
- building height (present ground level to roof ridge) – maximum 16 m.
- elements of the facade decorations can jut above the roof level – maximum 1.5 m.

Lot No. 14:

- roof type – peaked
- facade layout – 3 storeys + gable
- building height (present ground level to roof ridge) – maximum 18 m.
- elements of the facade decorations can jut above the roof level – maximum 1.5 m.

3. Tobiasza Area B

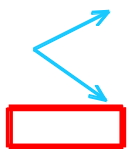
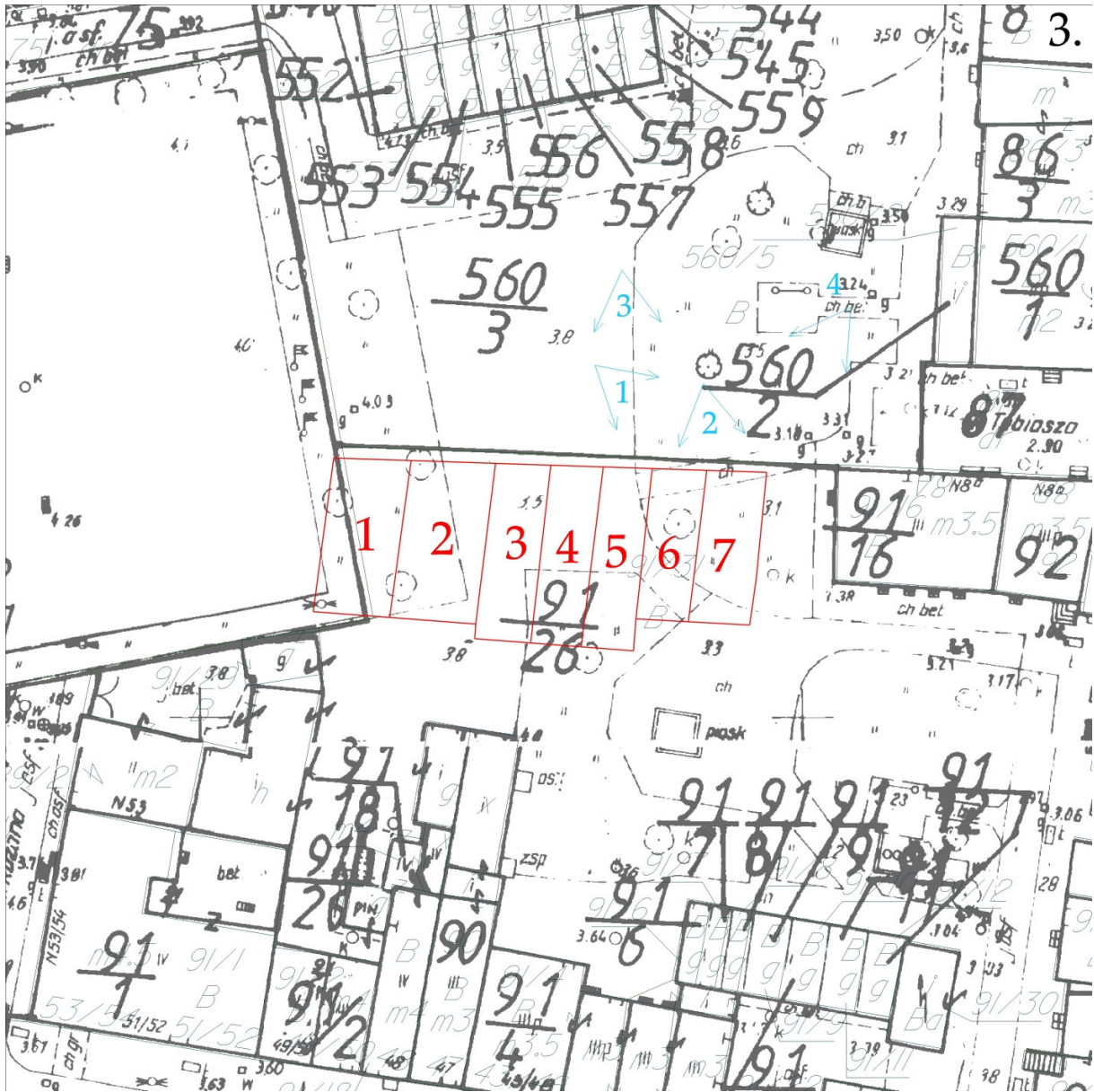

- photos taken from
- townhouses

3. Tobiasza Area B



3. Tobiasza Area B

TOBIASZA STREET Area B

Lot No. 1:

- roof type – peaked
- facade layout – 4 storeys + gable
- building height (present ground level to roof ridge) – maximum 19 m.
- elements of the facade decorations can jut above the roof level – maximum 1.5 m.

Lot No. 2:

- roof type – peaked
- facade layout – 4 storeys + gable
- building height (present ground level to roof ridge) – maximum 19 m.
- elements of the facade decorations can jut above the roof level – maximum 1.5 m.

Lot No. 3:

- roof type – peaked
- facade layout – 3 storeys + gable
- building height (present ground level to roof ridge) – maximum 16 m.
- elements of the facade decorations can jut above the roof level – maximum 1.5 m.

Lot No. 4:

- roof type – peaked
- facade layout – 3 storeys + gable
- building height (present ground level to roof ridge) – maximum 16 m.
- elements of the facade decorations can jut above the roof level – maximum 1.5 m.

Lot No. 5:

- roof type – peaked
- facade layout – 3 storeys + gable
- building height (present ground level to roof ridge) – maximum 16 m.
- elements of the facade decorations can jut above the roof level – maximum 1.5 m.

Lot No. 6:

- roof type – peaked
- facade layout – 3 storeys + gable
- building height (present ground level to roof ridge) – maximum 16 m.
- elements of the facade decorations can jut above the roof level – maximum 1.5 m.

Lot No. 7:

- roof type – peaked
- facade layout – 2 storeys + gable
- building height (present ground level to roof ridge) – maximum 13 m.
- elements of the facade decorations can jut above the roof level – maximum 1.5 m.

4. Grobla III - Straganiarska

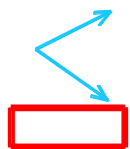
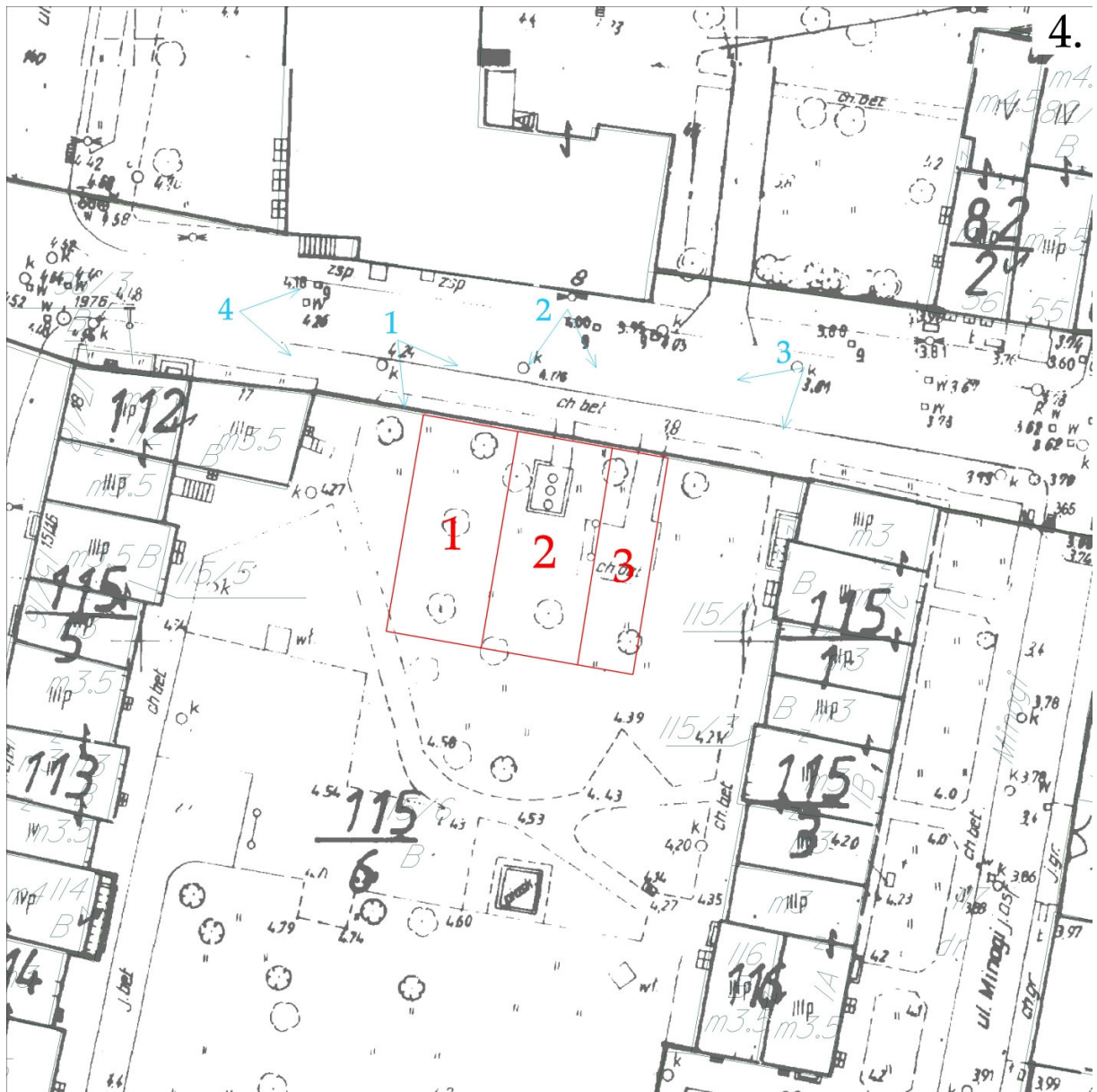

- photos taken from

- townhouses

4. Grobla III - Straganiarska



4. Grobla III - Straganiarska

STRAGANIARSKA STREET:

Lot No. 1:

- roof type – peaked
- facade layout – 4 storeys + gable
- building height (present ground level to roof ridge) – maximum 19 m.
- elements of the facade decorations can jut above the roof level – maximum 1.5 m.

Lot No. 2:

- roof type – peaked
- facade layout – 4 storeys + gable
- building height (present ground level to roof ridge) – maximum 19 m
- elements of the facade decorations can jut above the roof level – maximum 1.5 m.

Lot No. 3:

- roof type – peaked
- facade layout – 2 storeys + gable
- building height (present ground level to roof ridge) – maximum 13 m
- elements of the facade decorations can jut above the roof level – maximum 1.5 m.

5. Grobla III - Świętojańska

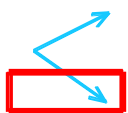
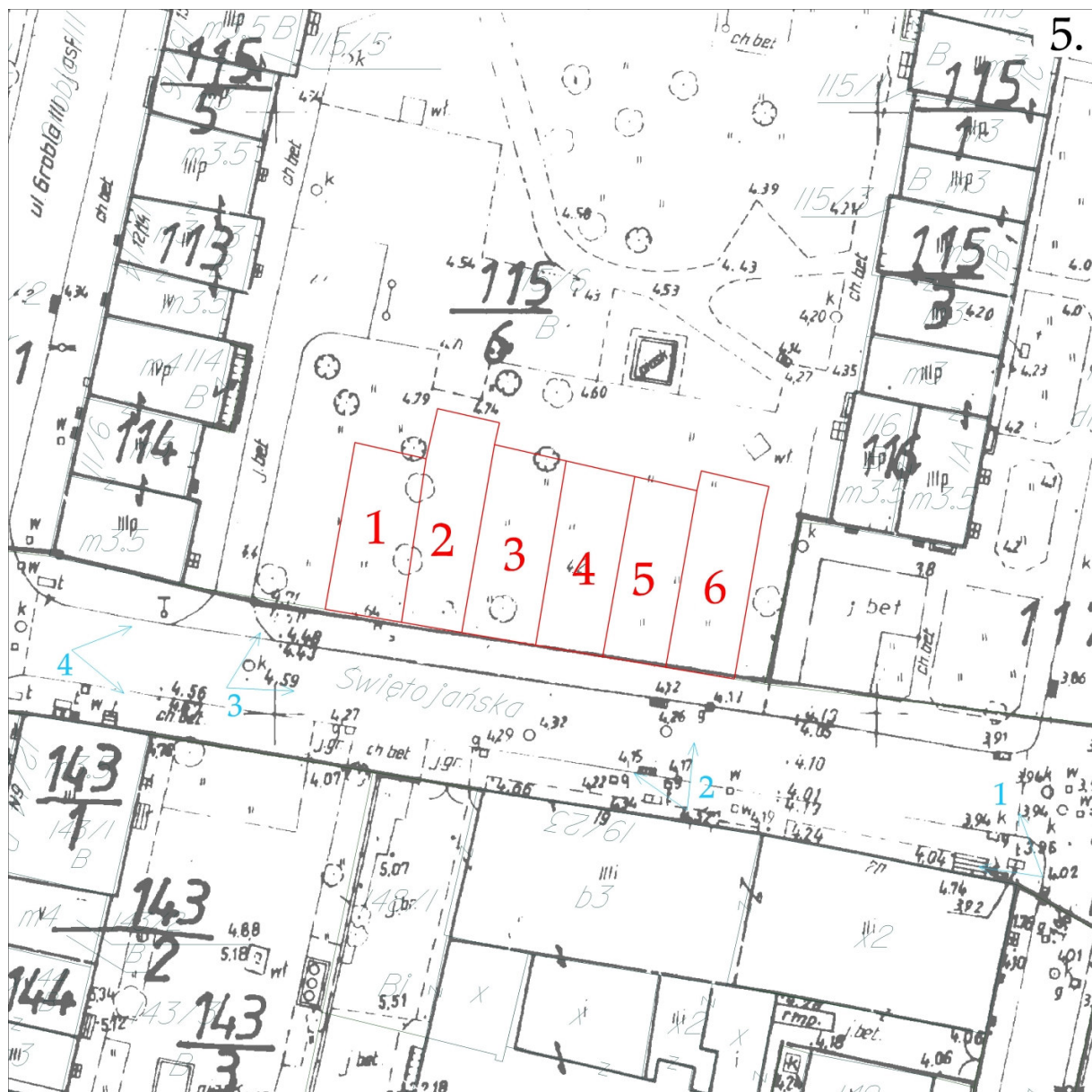

- photos taken from
- townhouses

5. Grobla III - Świętojańska



5. Grobla III - Świętojańska

ŚWIĘTOJAŃSKA STREET

Lot No. 1:

- roof type – peaked
- facade layout – 3 storeys + gable
- building height (present ground level to roof ridge) – maximum 16 m.
- elements of the facade decorations can jut above the roof level – maximum 1.5 m.

Lot No. 2:

- roof type – peaked
- facade layout – 4 storeys + gable
- building height (present ground level to roof ridge) – maximum 19 m
- elements of the facade decorations can jut above the roof level – maximum 1.5 m.

Lot No. 3:

- roof type – peaked
- facade layout – 4 storeys + gable
- building height (present ground level to roof ridge) – maximum 19 m
- elements of the facade decorations can jut above the roof level – maximum 1.5 m

Lot No. 4:

- roof type – peaked
- facade layout – 4 storeys + gable
- building height (present ground level to roof ridge) – maximum 19 m.
- elements of the facade decorations can jut above the roof level – maximum 1.5 m.

Lot No. 5:

- roof type – peaked
- facade layout – 4 storeys + gable
- building height (present ground level to roof ridge) – maximum 19 m
- elements of the facade decorations can jut above the roof level – maximum 1.5 m.

Lot No. 6:

- roof type – peaked
- facade layout – 3 storeys + gable
- building height (present ground level to roof ridge) – maximum 16 m
- elements of the facade decorations can jut above the roof level – maximum 1.5 m.

6. Szeroka, Tokarska

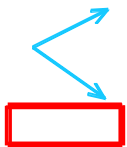
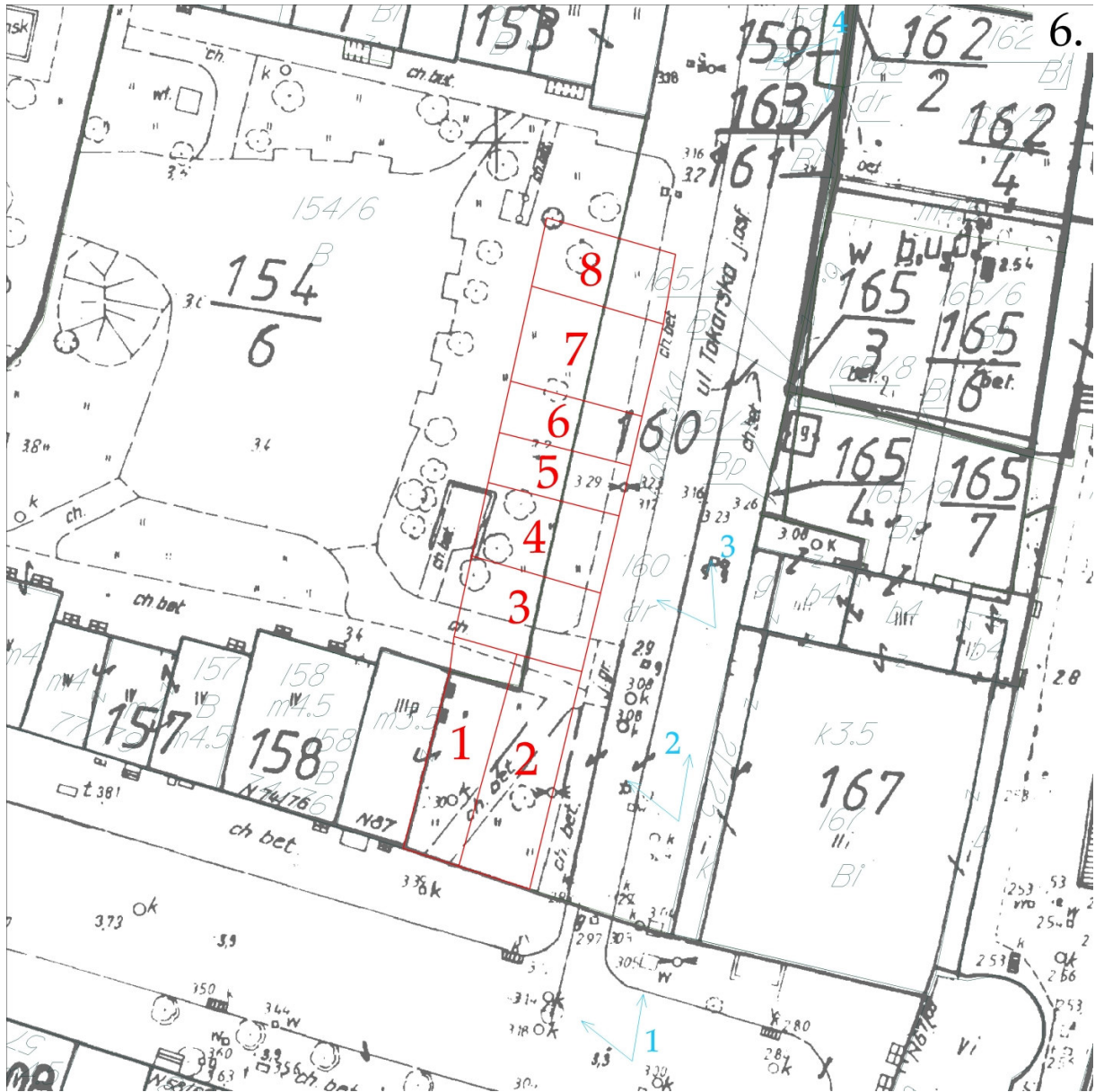

- photos taken from
- townhouses

6. Szeroka, Tokarska



6. Szeroka, Tokarska

SZEROKA STREET

Lot No. 1:

- roof type – peaked
- facade layout – 4 storeys + gable
- building height (present ground level to roof ridge) – maximum 19 m.
- elements of the facade decorations can jut above the roof level – maximum 1.5 m.
- obligatory terraced basement in the front; possible retail outlet in the basement

Lot No. 2:

- roof type – peaked
- facade layout – 3 storeys + gable
- building height (present ground level to roof ridge) – maximum 16 m
- elements of the facade decorations can jut above the roof level – maximum 1.5 m.
- obligatory terraced basement in the front; possible retail outlet in the basement

TOKARSKA STREET:

Lot No. 3:

- roof type – peaked
- facade layout – 3 storeys + gable
- building height (present ground level to roof ridge) – maximum 16 m
- elements of the facade decorations can jut above the roof level – maximum 1.5 m

Lot No. 4:

- roof type – peaked
- facade layout – 3 storeys + gable
- building height (present ground level to roof ridge) – maximum 16 m.
- elements of the facade decorations can jut above the roof level – maximum 1.5 m.

Lot No. 5:

- roof type – peaked
- facade layout – 2 storeys + gable
- building height (present ground level to roof ridge) – maximum 13 m
- elements of the facade decorations can jut above the roof level – maximum 1.5 m.

Lot No. 6:

- roof type – peaked
- facade layout – 2 storeys + gable
- building height (present ground level to roof ridge) – maximum 13 m
- elements of the facade decorations can jut above the roof level – maximum 1.5 m.

Lot No. 7:

- roof type – peaked
- facade layout – 4 storeys + gable
- building height (present ground level to roof ridge) – maximum 19 m
- elements of the facade decorations can jut above the roof level – maximum 1.5 m.

Lot No. 8:

- roof type – peaked
- facade layout – 3 storeys + gable
- building height (present ground level to roof ridge) – maximum 16 m
- elements of the facade decorations can jut above the roof level – maximum 1.5 m.

7. Klesza

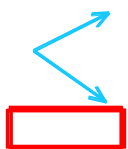
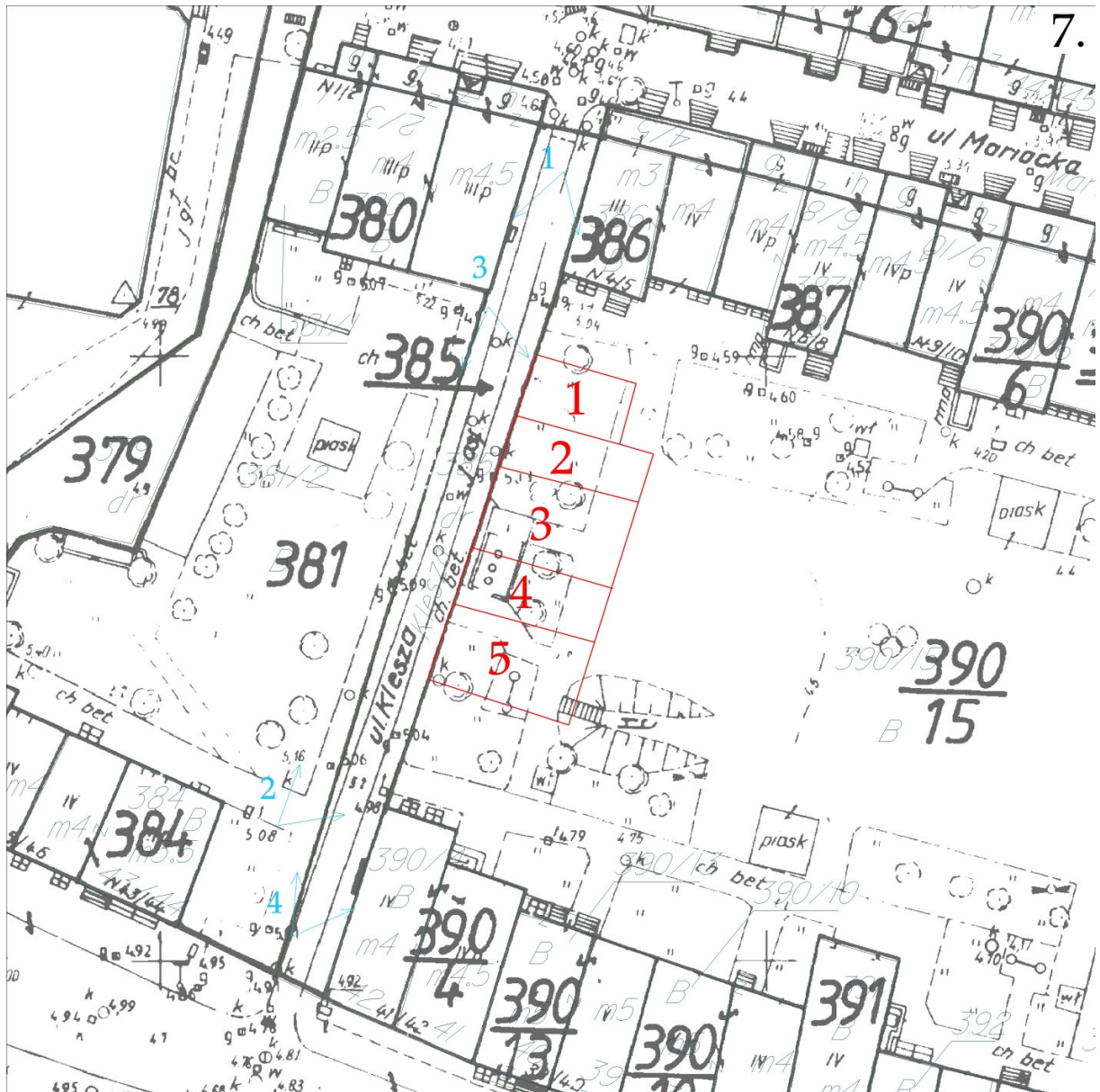

- photos taken from

- townhouses

7. Klesza

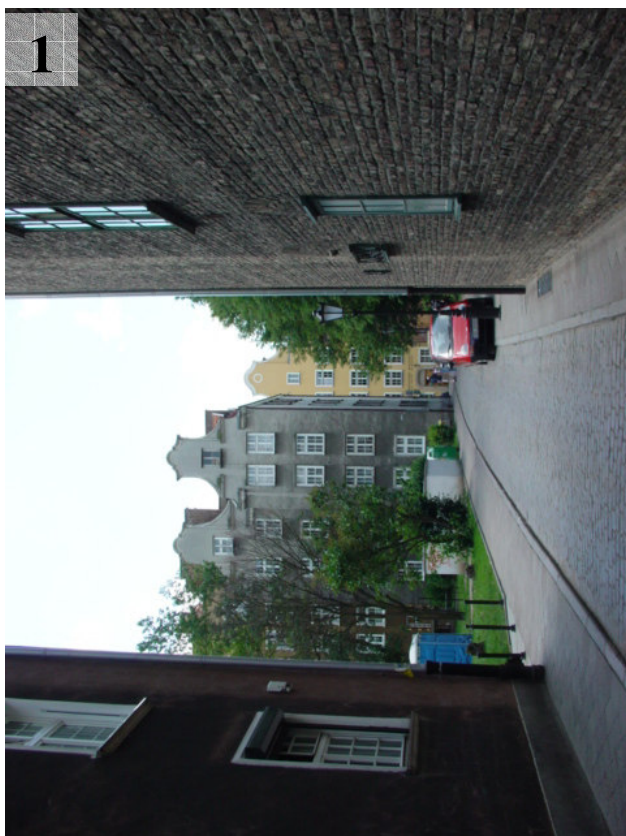

7. Klesza

KLESZA STREET:

Lot No. 1:

- roof type – peaked
- facade layout – 2 storeys + gable
- building height (present ground level to roof ridge) – maximum 12 m.
- elements of the facade decorations can jut above the roof level – maximum 1.5 m.

Lot No. 2:

- roof type – peaked
- facade layout – 3 storeys + gable
- building height (present ground level to roof ridge) – maximum 16 m
- elements of the facade decorations can jut above the roof level – maximum 1.5 m.

Lot No. 3:

- roof type – peaked
- facade layout – 3 storeys + gable
- building height (present ground level to roof ridge) – maximum 16 m
- elements of the facade decorations can jut above the roof level – maximum 1.5 m.

Lot No. 4:

- roof type – peaked
- facade layout – 3 storeys + gable
- building height (present ground level to roof ridge) – maximum 16 m
- elements of the facade decorations can jut above the roof level – maximum 1.5 m.

Lot No. 5:

- roof type – peaked
- facade layout – 4 storeys + gable
- building height (present ground level to roof ridge) – maximum 19 m
- elements of the facade decorations can jut above the roof level – maximum 1.5 m.

8. Grzaska

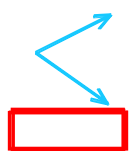
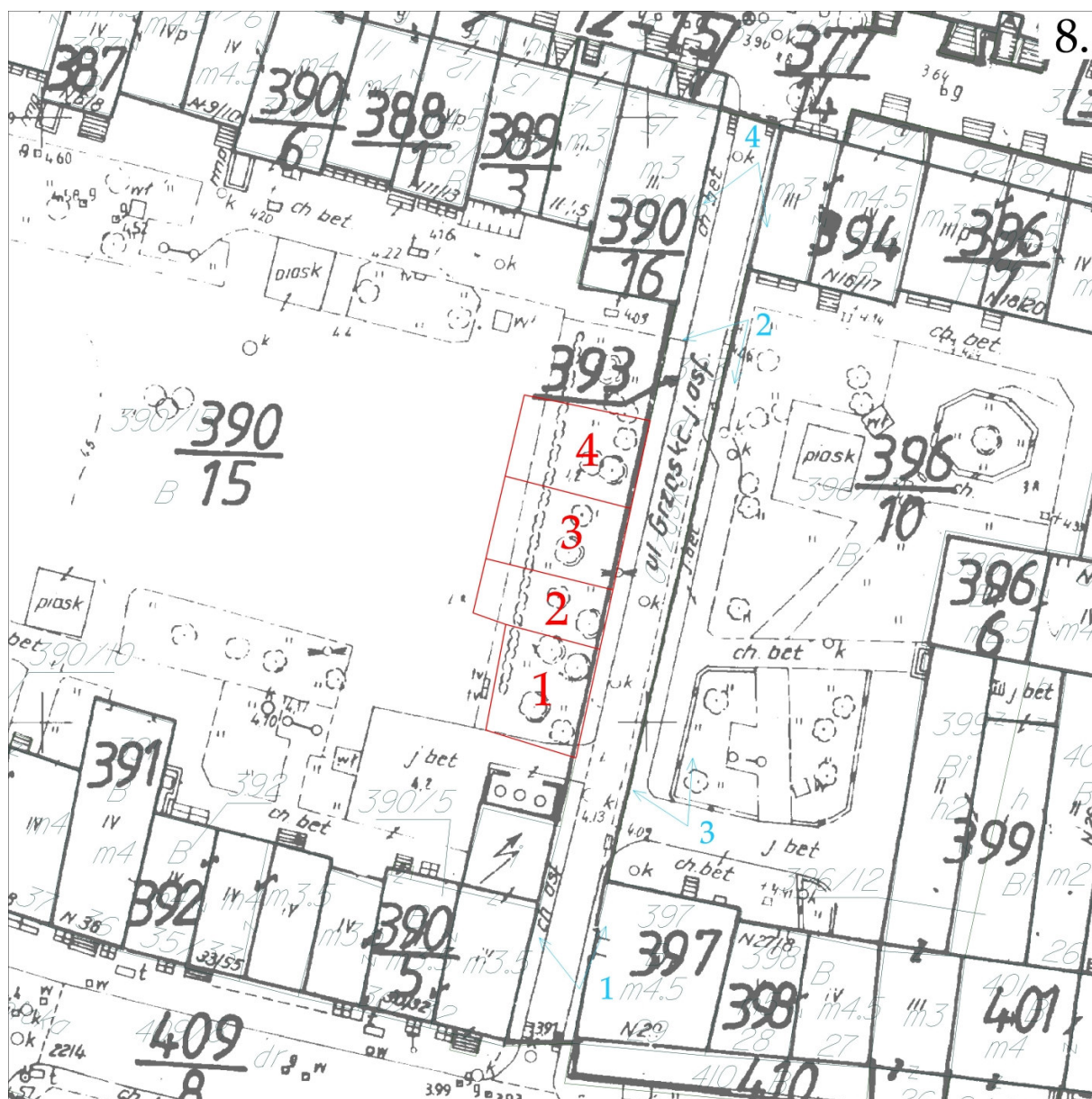

- photos taken from

- townhouses

8. Grzaska



8. Grzaska

GRZAŚKA STREET:

Lot No. 1:

- roof type – ridged
- facade layout – 3 storeys + gable
- building height (present ground level to roof ridge) – maximum 15 m.

Lot No. 2:

- roof type – peaked
- facade layout – 3 storeys + gable
- building height (present ground level to roof ridge) – maximum 16 m
- elements of the facade decorations can jut above the roof level – maximum 1.5 m.

Lot No. 3:

- roof type – peaked
- facade layout – 4 storeys + gable
- building height (present ground level to roof ridge) – maximum 19 m
- elements of the facade decorations can jut above the roof level – maximum 1.5 m.

Lot No. 4:

- roof type – peaked
- facade layout – 3 storeys + gable
- building height (present ground level to roof ridge) – maximum 16 m
- elements of the facade decorations can jut above the roof level – maximum 1.5 m.

9. Ławnicza

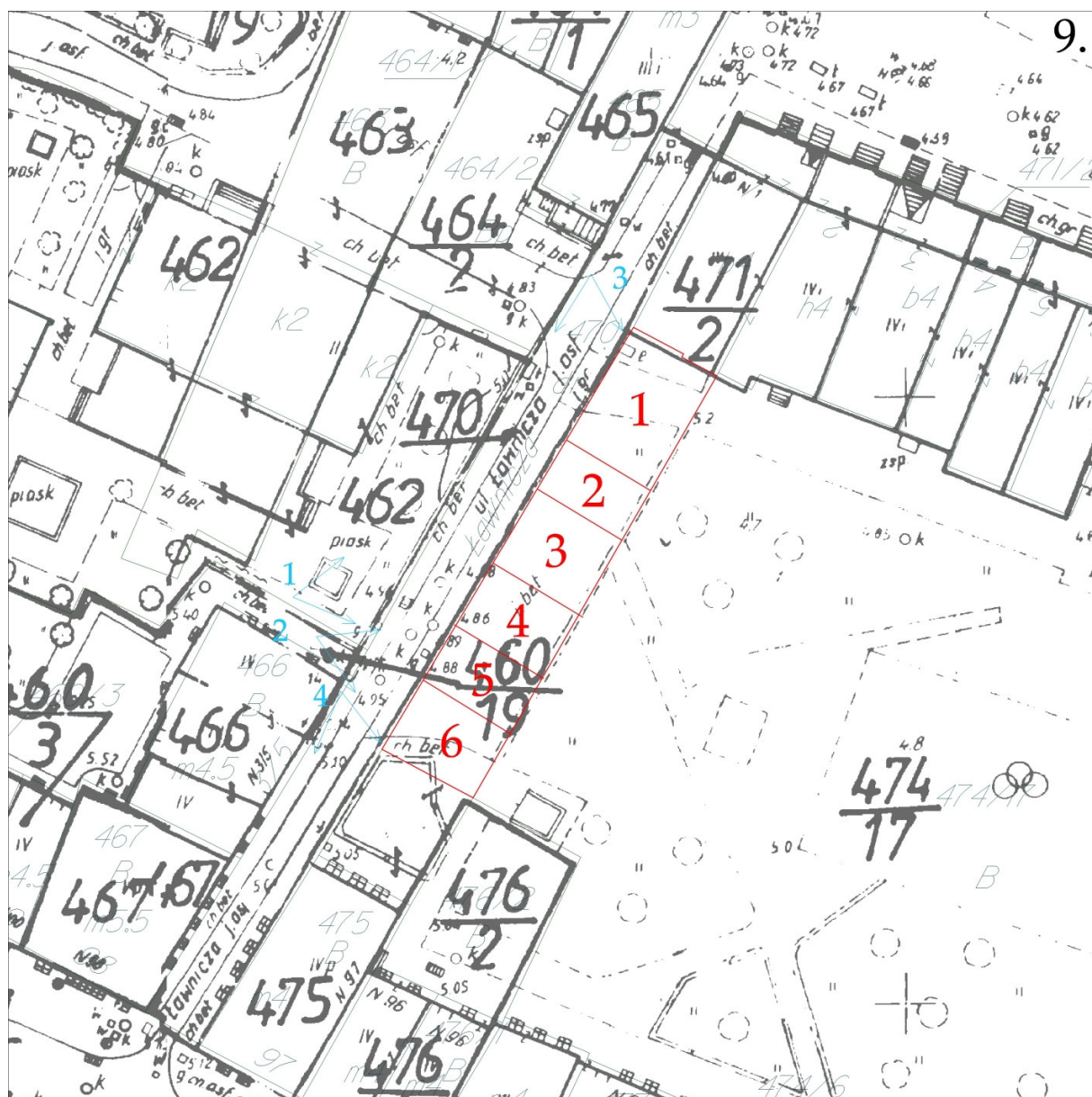

- photos taken from



- townhouses

9. Ławnicza



9. Ławnicza

ŁAWNICZA STREET

Lot No. 1:

- roof type – ridged
- facade layout – 3 storeys + gable
- building height (present ground level to roof ridge) – maximum 15 m.

Lot No. 2:

- roof type – peaked
- facade layout – 3 storeys + gable
- building height (present ground level to roof ridge) – maximum 16 m
- elements of the facade decorations can jut above the roof level – maximum 1.5 m.

Lot No. 3:

- roof type – peaked
- facade layout – 4 storeys + gable
- building height (present ground level to roof ridge) – maximum 19 m
- elements of the facade decorations can jut above the roof level – maximum 1.5 m.

Lot No. 4:

- roof type – peaked
- facade layout – 4 storeys + gable
- building height (present ground level to roof ridge) – maximum 19 m
- elements of the facade decorations can jut above the roof level – maximum 1.5 m.

Lot No. 5:

- roof type – peaked
- facade layout – 2 storeys + gable
- building height (present ground level to roof ridge) – maximum 12 m
- elements of the facade decorations can jut above the roof level – maximum 1.5 m.

Lot No. 6:

- roof type – peaked
- facade layout – 3 storeys + gable
- building height (present ground level to roof ridge) – maximum 16 m
- elements of the facade decorations can jut above the roof level – maximum 1.5 m.

10. Ogarna

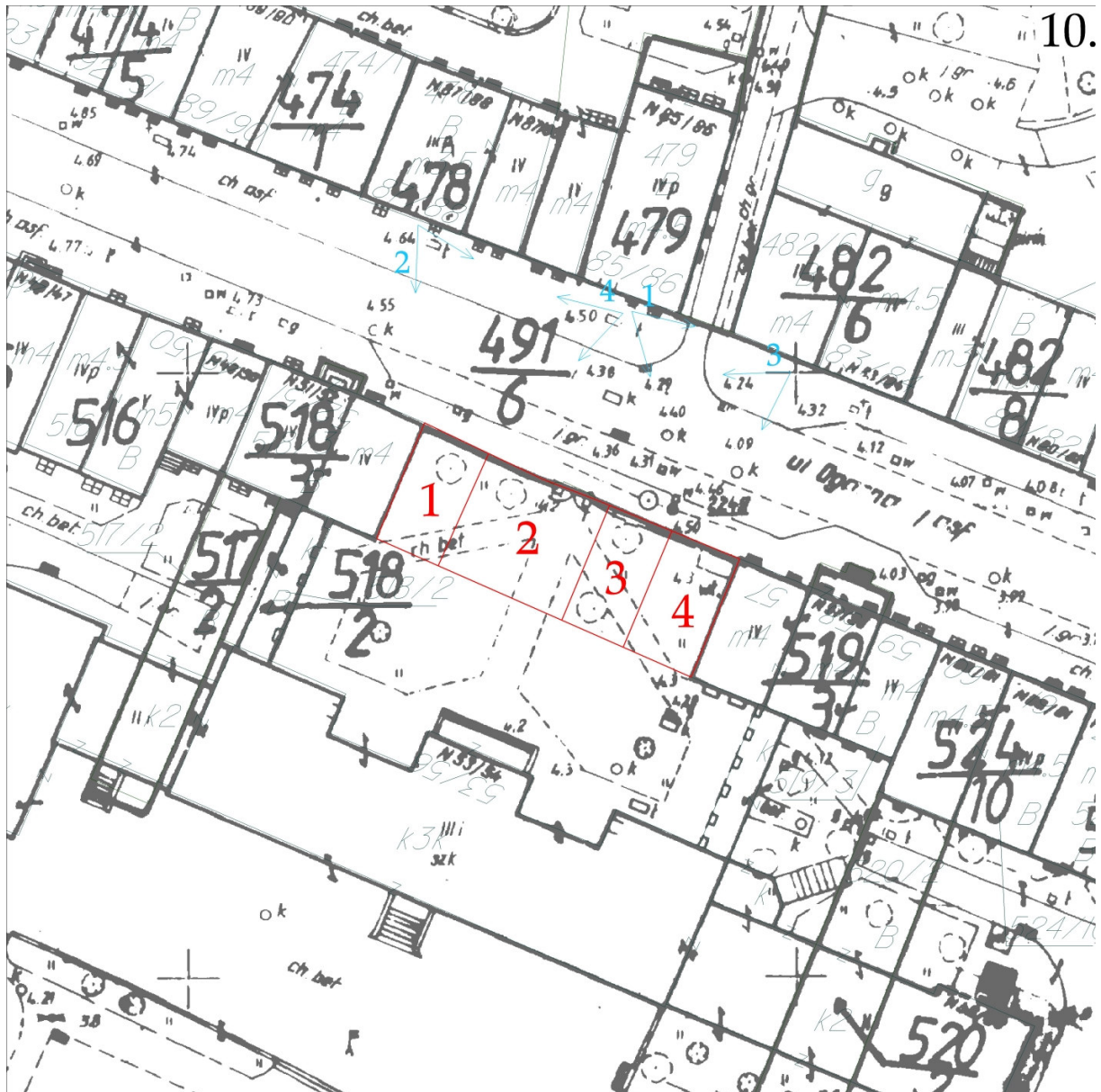

10.

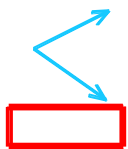

- photos taken from

- townhouses

10. Ogarna



10. Ogarna

OGARNA STREET

Lot No. 1:

- roof type – peaked
- facade layout – 4 storeys + gable
- building height (present ground level to roof ridge) – maximum 19 m
- elements of the facade decorations can jut above the roof level – maximum 1.5 m,
- obligatory terraced basement in the front

Lot No. 2:

- roof type – peaked
- facade layout – 5 storeys + gable
- building height (present ground level to roof ridge) – maximum 22 m
- elements of the facade decorations can jut above the roof level – maximum 1.5 m.
- the façade must include the surviving portal, and a passage to the Culture Centre site

Lot No. 3:

- roof type – peaked
- facade layout – 4 storeys + gable
- building height (present ground level to roof ridge) – maximum 19 m
- elements of the facade decorations can jut above the roof level – maximum 1.5 m.
- obligatory terraced basement in the front

Lot No. 4:

- roof type – peaked
- facade layout – 3 storeys + gable
- building height (present ground level to roof ridge) – maximum 19 m
- elements of the facade decorations can jut above the roof level – maximum 1.5 m.
- obligatory terraced basement in the front

11. Mniszki, Katarzynki

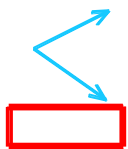
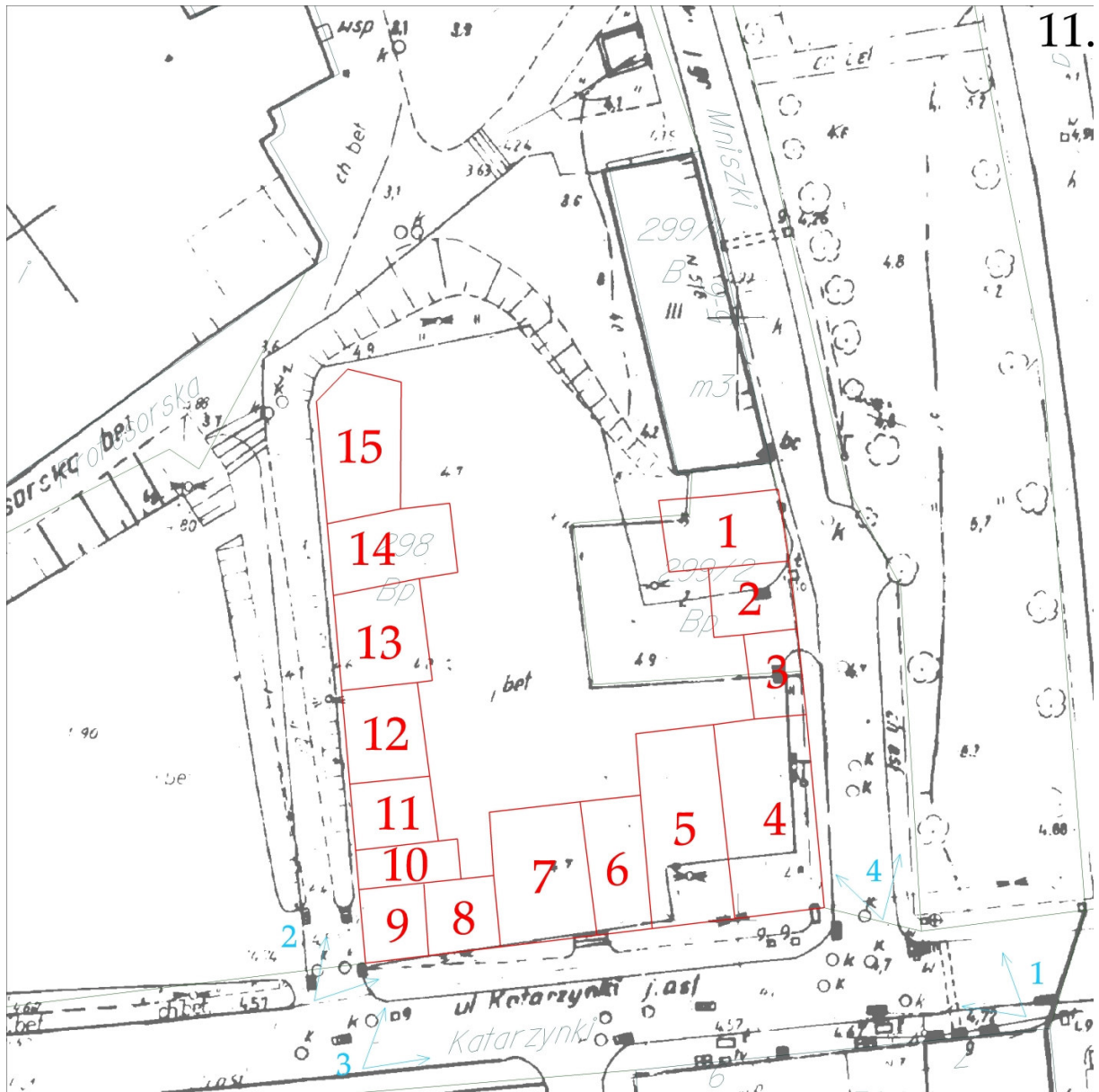

- photos taken from

- townhouses

11. Mniszki, Katarzynki



11. Mniszki, Katarzynki

MNISZKI STREET

Lot No. 1:

- roof type – peaked
- facade layout – 3 storeys + gable
- building height (present ground level to roof ridge) – maximum 16 m.
- elements of the facade decorations can jut above the roof level – maximum 1.5 m.

Lot No. 2:

- roof type – peaked
- facade layout – 2 storeys + gable
- building height (present ground level to roof ridge) – maximum 13 m.
- elements of the facade decorations can jut above the roof level – maximum 1.5 m

Lot No. 3:

- roof type – ridged
- facade layout – 2 storeys + gable
- building height (present ground level to roof ridge) – maximum 13 m.

KATARZYNKI STREET

Lot No. 4:

- roof type – peaked
- facade layout – 4 storeys + gable
- building height (present ground level to roof ridge) – maximum 19 m.
- elements of the facade decorations can jut above the roof level – maximum 1.5 m.

Lot No. 5:

- roof type – peaked
- facade layout – 4 storeys + gable
- building height (present ground level to roof ridge) – maximum 19 m.
- elements of the facade decorations can jut above the roof level – maximum 1.5 m.

Lot No. 6:

- roof type – peaked
- facade layout – 3 storeys + gable
- building height (present ground level to roof ridge) – maximum 16 m.
- elements of the facade decorations can jut above the roof level – maximum 1.5 m.

Lot No. 7:

- roof type – peaked
- facade layout – 3 storeys + gable
- building height (present ground level to roof ridge) – maximum 16 m.
- elements of the facade decorations can jut above the roof level – maximum 1.5 m.

Lot No. 8:

- roof type – peaked
- facade layout – 2 storeys + gable
- building height (present ground level to roof ridge) – maximum 13 m.
- elements of the facade decorations can jut above the roof level – maximum 1.5 m.

Lot No. 9:

- roof type – peaked
- facade layout – 2 storeys + gable
- building height (present ground level to roof ridge) – maximum 13 m.
- elements of the facade decorations can jut above the roof level – maximum 1.5 m.

Lot No. 10:

- roof type – peaked
- facade layout – 2 storeys + gable
- building height (present ground level to roof ridge) – maximum 13 m.
- elements of the facade decorations can jut above the roof level – maximum 1.5 m.

Lot No. 11:

- roof type – peaked
- facade layout – 2 storeys + gable
- building height (present ground level to roof ridge) – maximum 13 m.
- elements of the facade decorations can jut above the roof level – maximum 1.5 m.

Lot No. 12:

- roof type – ridged
- facade layout – 3 storeys + gable
- building height (present ground level to roof ridge) – maximum 16 m.

Lot No. 13:

- roof type – ridged
- facade layout – 3 storeys + gable
- building height (present ground level to roof ridge) – maximum 16 m.
- elements of the facade decorations can jut above the roof level – maximum 1.5 m.

Lot No. 14:

- roof type – peaked
- facade layout – 3 storeys + gable
- building height (present ground level to roof ridge) – maximum 16 m.
- elements of the facade decorations can jut above the roof level – maximum 1.5 m.

Lot No. 15:

- roof type – peaked
- facade layout – 3 storeys + gable
- building height (present ground level to roof ridge) – maximum 16 m.
- elements of the facade decorations can jut above the roof level – maximum 1.5 m.